



## FILTERING ESCAPE DEVICE



The EVAMASQUE is a light and compact 15 minutes filtering escape device which provides effective protection during the evacuation of accidentally polluted areas which volume of oxygen in atmosphere is more than 17%.

It is particularly suited to the conditions of use in Oil & Gas and chemical industries due to its broad spectrum gas filtration coverage with the ABEK filter.

The EVAMASQUE filtering escape device is safe, convenient and easy to use.



Oil & Gas



Chemical

The EVAMASQUE filtering escape device is only intended for use in emergency situations (compliant with the DIN58647-7 standard).

With a robust red protective casing, made in high impact polystyrene (HIPS), the product is protected from shocks to ensure the integrity of the half-mask and the filter.

The EVAMASQUE filtering escape device has been designed for a long lifetime with minimum maintenance: It can be stored during 12 years. The ABEK filter must be changed every 4 years to ensure full efficiency. The others components (half-mask and protective casing) are also available for change if required.

PROTECTION

- The EVAMASQUE filtering escape device provides a high level of protection due to its ABEK filter. Its filter provides a broad spectrum protection against organic, inorganic gases and vapours, sulphur dioxide, hydrogen chloride and other acid gases, ammonia and organic ammonium compounds.

SAFETY

- The EVAMASQUE filtering escape device can be worn around the waist belt, always within hand reach in case of an emergency: the user only has to open the protective casing and put it on.
- The EVAMASQUE filtering escape device is packed inside a robust protective casing which protects the filtering escape device against accidental damage and contamination.
- The EVAMASQUE can only be used in atmosphere with more than 17% of oxygen.

COMFORT AND CONVENIENCE

- Label with validity date on the packaging and the protective casing: immediate visibility of the expiration date.
- The user’s field of vision is not obstructed due to the low position of the filter on the half-mask.
- The exhalation valve reduces the breathing resistance, providing better

comfort. This point is very important in a situation of evacuation as, in such a case, the breathing rate increases.

- Compact, light and worn around the waist belt it does not disturb the user during its work.



SPECIFICATIONS	
Gross weight (with casing) / Net weight (without casing)	440 gr / 365 gr
Product dimensions / Packaging dimensions	15,4 x 10,5 x 8 cm / 16 x 15 x 13 cm - individual packed
Standard	DIN 58647-7
Protection factor	NPF (nominal protection factor) : 50 / APF (assigned protection factor) : 10

MATERIAL	
Skirt	Black EPDM
Inhalation Valve / Exhalation Valve	Neoprene / Black Silicone
Filter	ABEK Charcoal, aluminium casing
Box	Red high impact polystyrene
Strap	Elastomeric
Adhesive tape	Coated textile

ORDERING INFORMATION	PART NUMBER
EVAMASQUE complete with ABEK filter	17 285 70
ABEK replacement anti-gas filter (includes label with validity date + elastic strap)	17 285 71
Protective box (with beltclip and strap)	17 799 93
Adhesive tape - 50 meters (allows for sealing of about 90 units)	17 288 21
100 x disinfecting wipes	17 266 02
EVAMASQUE alone with elastic strap and no filter	17 285 02

# EVAMASQUE FILTERING ESCAPE DEVICE

REF. : 17 285 70



## Description

The EVAMASQUE is a 15 min filtering escape device which provides an effective protection during the evacuation of accidentally polluted areas which volume of oxygen in atmosphere is more than 17%.

It is particularly suited to the conditions of use in oil and gas and chemical industries due to its broad spectrum gas filtration coverage with the ABEK filter. It is also compatible with other items of PPE such as spectacles or helmets.

The EVAMASQUE filtering escape device is safe, practical and easy to use.

It is small, neatly packed in a robust protective casing to be carried or stored easily for long period of times, up to 12 years (4 years without maintenance, 12 years with 2 filter changes).

The EVAMASQUE filtering escape device ensures maximum protection for escape situations.

It is only intended for use in emergency situations.

## Benefits

- Effective protection.
- Light and Compact.
- Quick and Easy to use.
- Excellent visual comfort.

## Standards

- EVAMASQUE : DIN 58647-7  
Respiratory protective devices for self-rescue,  
Part 7: Filtering devices for self-rescue.

## Characteristics

- **Size** : One size.
- **Storage time** : 12 years with 2 filter changes  
(filter shelf life : 4 years without maintenance).
- **Storage conditions** :

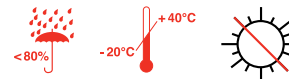

- **Net Weight** : 365g
- **Dimensions of product** : 15,5 x 10 x 8 cm
- **Packaging** : - Individually packed 15 x 11,5 x 11,5 cm  
- Shipping box : 50 units
- **Nominal Protection Factor (NPF)** : 50
- **Material**
  - Mask moulded in Black EPDM, equipped with Neopren inhalation Valve, Silicone exhalation valves and elastomeric strap.
  - Filter : Carbone, Paper and non-woven PA.
  - Casing : Red Polystyren.
  - Adhesive tape.

## Maintenance

- Main components can be changed.
- For details please refer to the user manual.
- Part numbers for maintenance :

N°	Part Numbers	Description
1	17 285 02	EVAMASQUE half-mask alone (no filter, no casing)
2	17 285 71	ABEK replacement anti-gas filter with replacement elastic strap + seal ribbon
3	17 799 93	Protective shell with belt clip and clamp
4	17 288 21	Adhesive tape - 50 meters 4 (allows for sealing of about 90 units)

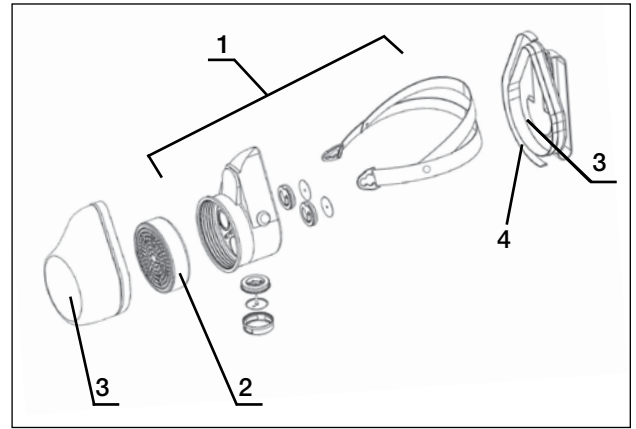

## Product Use

### Cleaning :

- Clean the half mask with warm soapy cloth, not under running water.
- Carefully dry before putting it back to storage.

### User's instructions

- Make sure that the transport box is not damaged.



### FILTER CAPACITY ACCORDING TO THE DIN58647-7 STANDARD

Filter Type	Test gas	Test gas concentration in air		Minimum breakthrough time of class
		Vol. -%	mg/l	
A ■	Cyclohexane (C6H12)	0.25	8.7	15
B ■	Chlorine (Cl2)	0.25	7.4	15
B ■	Hydrogen sulphide (H2S)	0.25	3.6	15
B ■	Hydrogen cyanide (HCN)	0.25	2.8	15
E ■	Sulphur dioxide (SO2)	0.25	6.7	15
K ■	Ammonia (NH3)	0.25	1.8	15
B ■	Hydrogen sulphide (H2S)	1.0*	14.2	5

(\*) To estimate the gas filter's breakthrough safety, it is also tested with 1.0 Vol. -% sulphur dioxide. Test conditions 30L/mn, 70% relative humidity, 20°C

### Warnings :

- Do not use the filtering escape device if an effective face seal cannot be achieved.  
Refer to Maintenance Instructions.
- The seal of the filtering escape device is also affected by size and facial structure of the user, e.g. beard hair, etc.
- Do not remove the filtering escape device before leaving the contaminated area.
- The filtering escape device provides limited protection against low boiling point solvents
- The filtering escape device provides limited protection against high concentrations of hazardous substances (The filtration duration will be reduced, or filter can become inefficient at very high concentrations).
- Do not use filtering escape devices in tanks and confined spaces where there is a risk of oxygen deficiency
- The filtering escape device is designed for use in escape situations only. Please consult the supplier if you have any doubt as to whether the respirator is suitable for the situation in which you intend to use it.
- Leave the area as soon as the vapour or odour of the contaminants becomes noticeable.  
The filter is «saturated». It has to be changed.
- Not efficient against carbon monoxide (CO).